

8

7

6

5

4

3

1195T-01

3

A

NOTES: UNLESS OTHERWISE SPECIFIED

1. XXX

REV	DESCRIPTION	DATE	DRAWN BY	APPROVED
A	ENGINEERING RELEASE	9/29/05	MJL	-

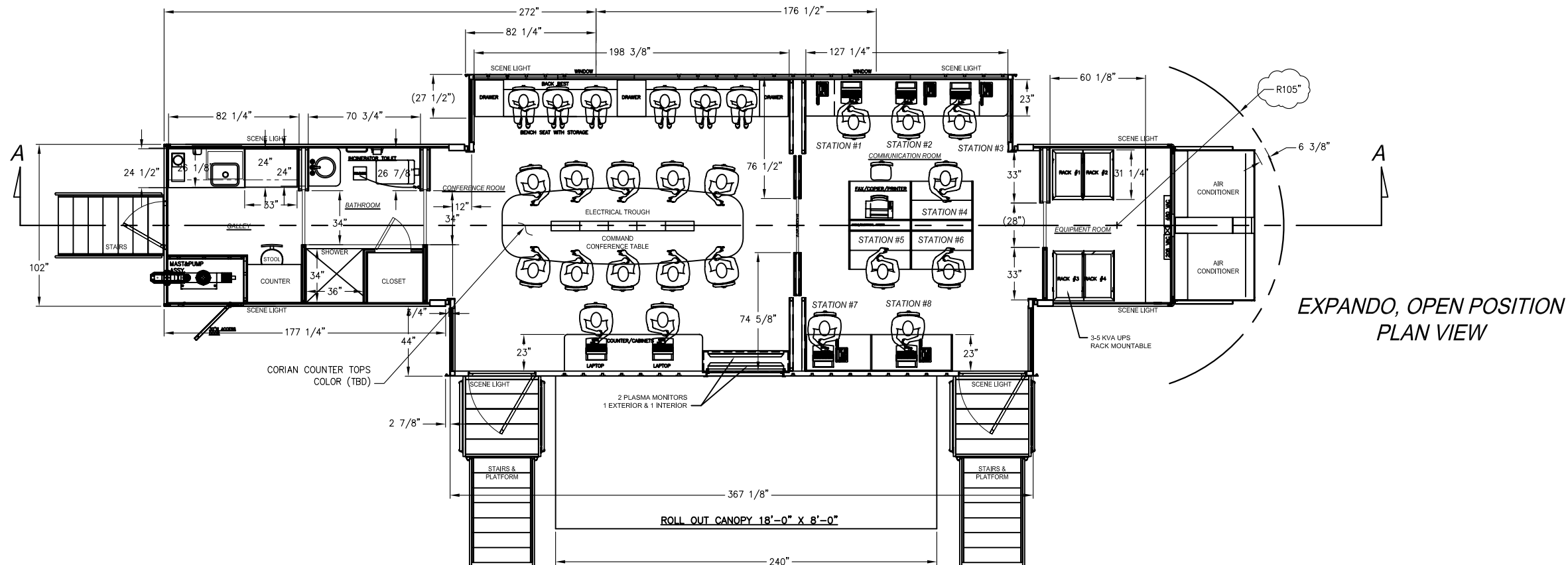

EXPANDO, OPEN POSITION PLAN VIEW

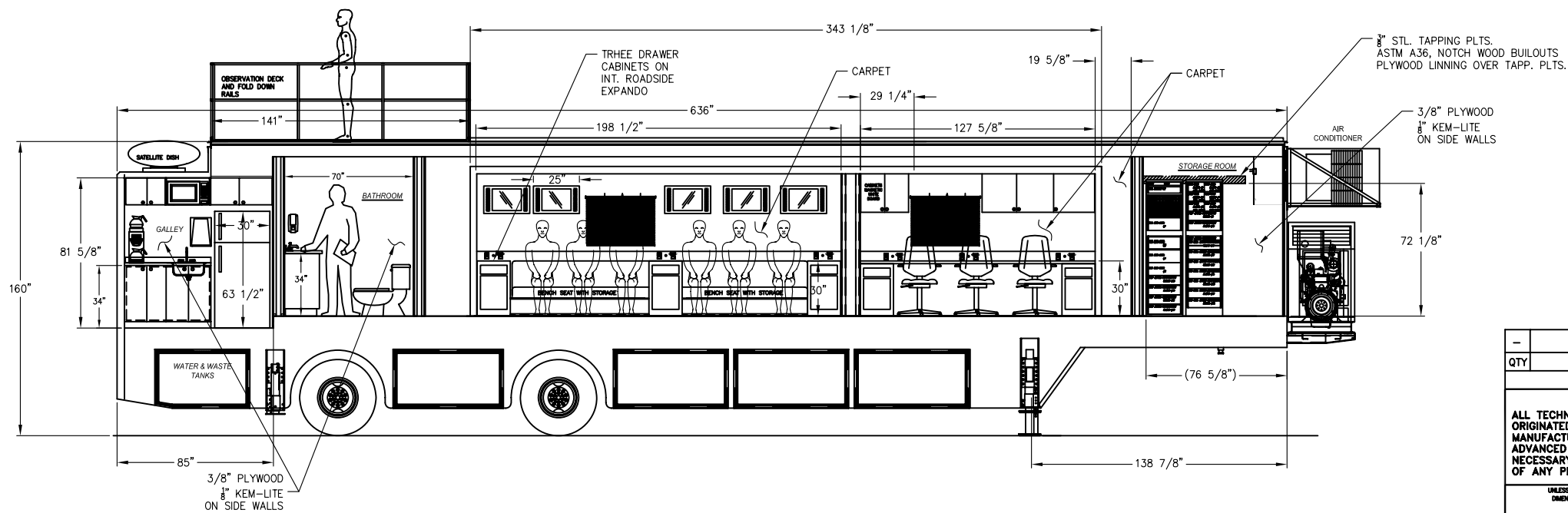

SECTION A-A

QTY	DESCRIPTION	PART NUMBER	MANUFACTURER	VENDOR/SUPPLIER No.
-	-	-	-	1
Bill Of Material				
<p>NOTICE : PROPRIETARY INFORMATION            ALL TECHNICAL INFORMATION AND THE DESIGN DISCLOSED IN THIS DRAWING OR IN ANY ACCOMPANYING TECHNICAL DATA WAS ORIGINATED BY AND IS THE PROPERTY OF AMPSYSTEMS, ADVANCED MOBILE PRODUCTS DIVISION. ALL PROPRIETARY, DESIGN, MANUFACTURING, REPRODUCTION, USE AND SALES RIGHTS IN ANY INFORMATION DISCLOSED HEREIN ARE RESERVED BY AMPSYSTEMS, ADVANCED MOBILE PRODUCTS DIVISION. NO RIGHT OR LICENSE TO USE ANY SUCH INFORMATION FOR ANY PURPOSE OTHER THAN AS NECESSARY FOR USE OR MAINTENANCE OF AMPSYSTEMS, ADVANCED MOBILE PRODUCTS DIVISION PRODUCTS IS GRANTED BY SALE OF ANY PRODUCT DESCRIBED HEREIN WITHOUT PRIOR WRITTEN CONSENT OF AMPSYSTEMS, ADVANCED MOBILE PRODUCTS DIVISION.</p>				
<small>UNLESS OTHERWISE SPECIFIED: DIMENSIONS ARE IN INCHES TOLERANCES</small>		<small>CONTRACT NO.</small> -		
<small>FRACTIONS</small> -		<small>APPROVALS</small> MJ LOPEZ		
<small>DO NOT SCALE DRAWING</small>		<small>DATE</small> 7/05/05		
<small>TREATMENT</small> -		<small>DESIGNED</small> -		
<small>FRESH</small> -		<small>DATE</small> -		
<small>USE WITH DRAWING(S)</small> -		<small>JOB NUMBER</small> -		
<small>SCALE</small> -		<small>CUSTOMER</small> -		
<small>AMPsystems</small>		<small>7820 Lincoln Avenue Riverside, Ca. 92504-4443 (909) 689-3900</small>		
<small>TITLE</small> ROCKDALE COUNTY SHERIFF INTERIOR VIEWS		<small>SIZE</small> D		
<small>SCALE</small> -		<small>CAGE CODE</small> 01572		<small>DWG. NO.</small> 1195T-01
<small>RELEASE DATE</small> -		<small>SHEET</small> 3 OF 6		<small>REVISION</small> A

8

7

6

5

4

3

2

1